

Our proposal for new generation HMI.
All the necessary switches can be displayed in midair while self-driving; the driver can easily operate without moving. We offer a stress-free HMI equipped with gesture control with tactile sensation.

* HMI: Human Machine Interface

■ Feature

- Gesture control with tactile sensation
- Sense of touch is achieved through ultrasonic waves (40KHz)
- No more stains thanks to gesture control switches.
- Breakdown and scratches due to contact can be prevented.

■ Applications

- HMI (gesture control) for vehicles

■ Specification

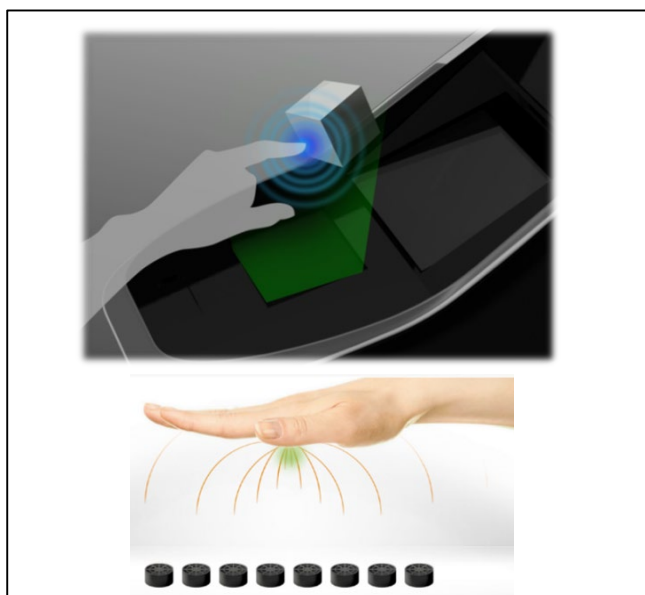

Item	Specifications	Notes
Resin plate size	200 × 200 × 5	
Virtual image viewing angle	±20° (up & down, left & right)	
Tactile feedback device	14 × 14 transducer array	
Tactile sensation generation range	10~50cm	
Tactile refresh rate	400Hz	
Operating range	0.3m~2m	
Resolution	VGA 30fps	640 × 480

This document was submitted in Oct. 2018